

Standard Construction Features

Belt Type: Synchronous
 Core Material: Polyurethane
 Cord/Tensile: Carbon
 Jacket: Blue Nylon

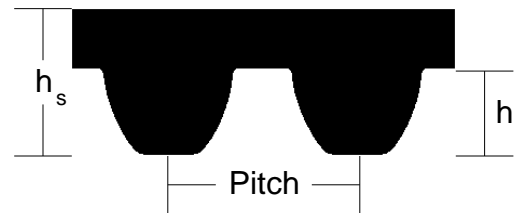

Belt Section Dimensions

Tooth Type	Pitch (mm)	h_s (mm)	h_t (mm)
GT	8.000	5.900	3.400

Belt Dimensions

Pitch Length (mm)	No. Teeth	Width (mm)
4480.00 + 1.440 - 1.440	560	21.000 + 0.630 - 0.630

Measuring Information

Y (mm)	T* (N)	No. Teeth	O.D. (mm)	Pitch Circum. (mm)	Radial Runout (mm)	Axial Runout (mm)	PLD 2a (mm)
2088.00 + 0.720 - 0.720	105	38	95.17	304.00	0.0005	0.0010	1.600

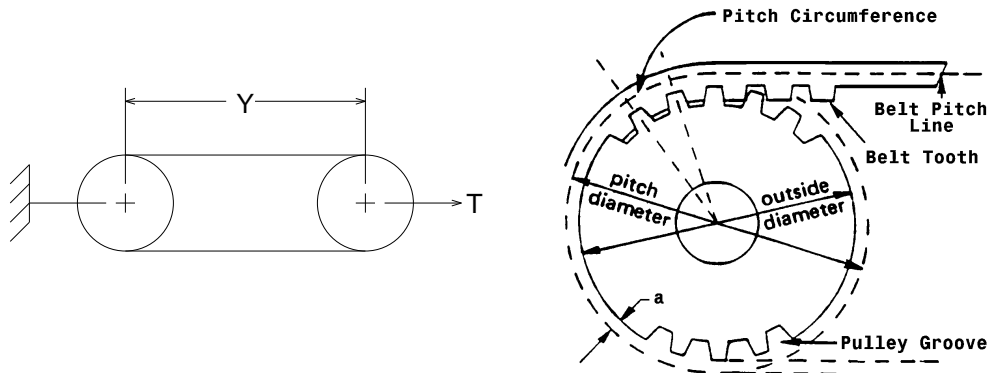

The length shall be measured by placing the belts on two pulleys of equal diameters that have been grooved in accordance with standard specifications and rotated at least three complete turns with the specified tension so that each strand receives half the total tension. The length will be that length obtained by adding the Pitch Circumference of one pulley to twice the center distance (dimension 'Y').

Application Version: 1.0.24 Database Version: 1.1.01



DesignView™

Belt Information Sheet

Gates Corporation
 Denver, CO

Created 30 Jan 2009 by www.gates.com

Created for

Poly Chain GT Carbon - 8MGT

Gates Product Number

9274-1560

Customer Part Number

8MGT-4480-21

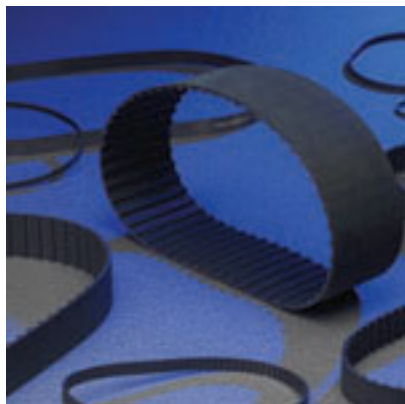
[Home](#) > [Synchronous Belts and Sprockets](#) > [Belts](#) > 8MGT-960-21**Product Details for 8MGT-960-21**

Category: Belts

[Print this page](#)

Attributes	Values
Product Number	92741120
Product Name	Poly Chain GT Carbon
Profile	GT
Pitch	8 mm
Number of Teeth	120
Top Belt Width per strand (inch)	0.83
Top Belt Width per strand (mm)	21.00
Length (inch)	37.80
Length (mm)	960
Core Material	Polyurethane
Tensile Cord	Carbon
Fabric Cover	Blue Nylon
RMA Oil and Heat Resistant	Yes
RMA Static Conductive	No
Weight (lbs)	0.95

Product Detail

[Close](#)

Product ID

77182036

Part

8MX-36S-21

Product Description

8MX-36S-21 1610 SPKT

UPC

072053270976

Category Hierarchy

Industrial Power Transmission -> Synchronous Metal -> Poly Chain® GT®2 Sprockets -> 8mm Pitch Sprockets, P.N. Series 7715 & 7718 -> For Belts 21mm Wide [Go](#)

Product Images



Product Features

Application

Features Advantages

Full split in bushing allows easy installation and removal. Poly Chain® GT®2 Sprockets keep overhung load below manufacturers recommendation. Precise sprocket design produces positive, press fit to shaft. Sprockets are precision manufactured and static balanced. Smaller, narrower sprockets save shaft space, keep the load closer to bearing and extend life of reducer.

Markets/Applications	Use with Poly Chain® GT®2, Poly Chain® GT® or Poly Chain® GT® Carbon® Belts.
Belt / Sprocket Specifications	
Bore Range (In.)	1/2 - 1 11/16
Bore or Bushing	1610
Number of Grooves	36
Pitch Diameter (In.)	3.609
Construction	
Material	SiS
Notes	
Belt Notes	<p>On a sprocket, pitch is the distance between groove centers and is measured on the pitch circle of the sprocket. The pitch circle of the sprocket coincides with the pitch line of the belt mating with it. The pitch diameter of the sprocket is always greater than its outside diameter.</p> <p>Abbreviations used for sprocket materials: GI=Gray Iron, DI=Ductile Iron, SiS=Sintered Steel, CI=Cast Iron.</p> <p>Sprocket part numbers are comprised of pitch, number of grooves and width. For example; part number 8MX-48S-12 denotes 8mm pitch, 48 grooves, "S" for sprocket and 12mm width.</p>
Warning	Do NOT use these sprockets with rim speeds in excess of 6,500 fpm.
Packaging	
Customer Pack	1.0
Standard Pack	1
Weight	
Weight (Lbs.)	2.12

Datasheet References

[Safety and Usage Disclaimer](#)

Close

Product Detail

[Close](#)

Product ID

77182032

Part

8MX-32S-21

Product Description

8MX-32S-21 1210 SPKT

UPC

072053270952

Category Hierarchy

Industrial Power Transmission -> Synchronous Metal -> Poly Chain® GT®2 Sprockets -> 8mm Pitch Sprockets, P.N. Series 7715 & 7718 -> For Belts 21mm Wide [Go](#)

Product Images



Product Features

Application

Features Advantages

Full split in bushing allows easy installation and removal. Poly Chain® GT®2 Sprockets keep overhung load below manufacturers recommendation.

Precise sprocket design produces positive, press fit to shaft. Sprockets are precision manufactured and static balanced. Smaller, narrower sprockets save shaft space, keep the load closer to bearing and extend life of reducer.

Markets/Applications	Use with Poly Chain® GT®2, Poly Chain® GT® or Poly Chain® GT® Carbon® Belts.
Belt / Sprocket Specifications	
Bore Range (In.)	1/2 - 1 1/4
Bore or Bushing	1210
Number of Grooves	32
Pitch Diameter (In.)	3.208
Construction	
Material	DI
Notes	
Belt Notes	<p>On a sprocket, pitch is the distance between groove centers and is measured on the pitch circle of the sprocket. The pitch circle of the sprocket coincides with the pitch line of the belt mating with it. The pitch diameter of the sprocket is always greater than its outside diameter.</p> <p>Abbreviations used for sprocket materials: GI=Gray Iron, DI=Ductile Iron, SiS=Sintered Steel, CI=Cast Iron.</p> <p>Sprocket part numbers are comprised of pitch, number of grooves and width. For example; part number 8MX-48S-12 denotes 8mm pitch, 48 grooves, "S" for sprocket and 12mm width.</p>
Warning	Do NOT use these sprockets with rim speeds in excess of 6,500 fpm.
Packaging	
Customer Pack	1.0
Standard Pack	1
Weight	
Weight (Lbs.)	3

Datasheet References

[Safety and Usage Disclaimer](#)

Close

TECHNICAL INFORMATION

Belt Drive Tensioners

(Double Adjustable)

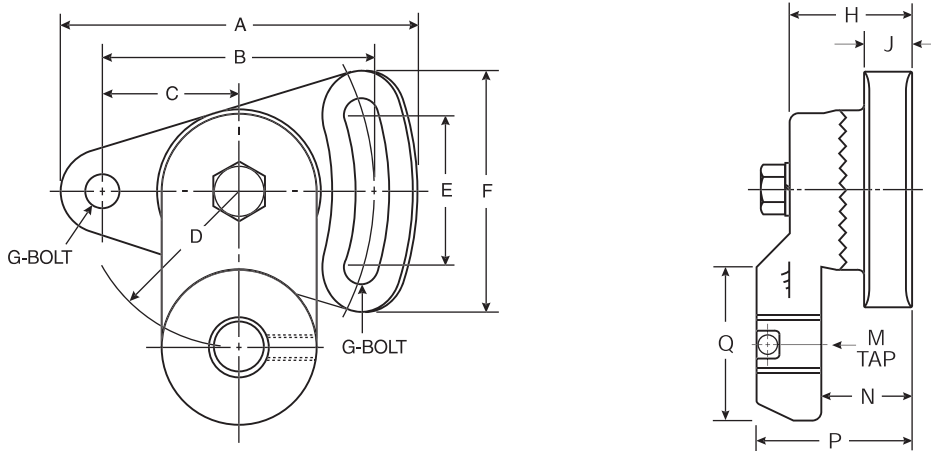

Idler Bracket Specifications

Part No.	Tensioner Part No.	Use With	A (in)	B (in)	C (in)	D (in)	E (in)	F (in)	G (in)	H (in)	J (in)	M (Threads)	N (in)	P (in)	Q (in)	Weight (lb)
05-IDL-BRAK	7720-1005	1610-IDL-BUSH	4.62	3.50	1.75	2.00	2.06	3.06	0.38	1.63	0.62	5/8-18	1.16	2.01	2.00	2.80
10-IDL-BRAK	7720-1010	8mm Pitch Idler Sprockets 2012-IDL-BUSH 2517-IDL-BUSH 20-IDL-BUSH (SK)	4.63	3.50	1.75	2.00	2.06	3.06	0.38	1.50	0.56	3/4-16	1.00	1.88	1.75	3.4
20-IDL-BRAK	7720-1020	14mm Pitch Idler Sprockets 30-IDL-BUSH (SF) 40-IDL-BUSH (E)	6.94	5.25	2.63	5.00	3.00	4.56	0.63	2.38	1.00	1-14	1.63	2.94	2.75	11.2

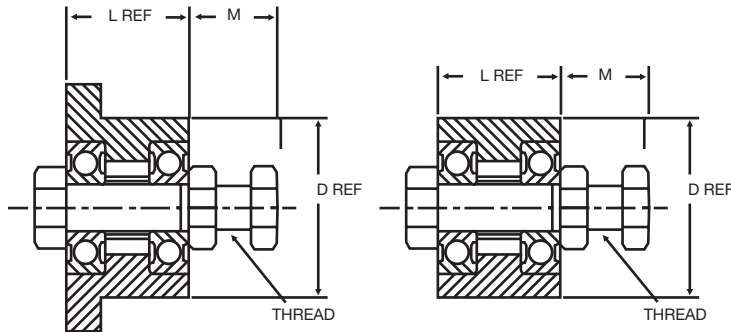

Idler Bushings (Internal Shaft Included)

Product No.	Part No.	Use with Bracket	D (in)	L (in)	M (in)	Threads	Weight (lb)
7720-1610	1610-IDL-BUSH	05-IDL-BRAK	2.25	1.00	1.38	5/8-18	1.30
7720-2012	2012-IDL-BUSH	10-IDL-BRAK	2.75	1.25	1.56	3/4-16	2.30
7720-2517	2517-IDL-BUSH	10-IDL-BRAK	3.38	1.75	1.56	3/4-16	3.90
7720-1120	20-IDL-BUSH (SK)	10-IDL-BRAK	2.81	1.94	1.44	3/4-16	4.10
7720-1130	30-IDL-BUSH (SF)	20-IDL-BRAK	3.13	2.08	2.13	1-14	6.40
7720-1140	40-IDL-BUSH (E)	20-IDL-BRAK	3.83	2.75	2.19	1-14	8.60

TECHNICAL INFORMATION

Idler Sprockets

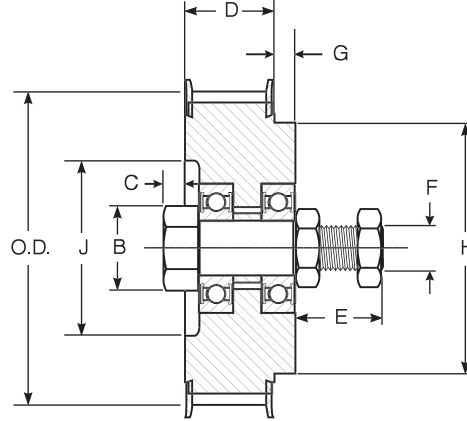

Poly Chain® GT®2 Idler Dimensions

Part No.	Product No.	Use With	Size Designation	Belt Width (mm)	No. of Teeth	O.D. (in)	B Ref. (in)	C (in)	D (in)	E Ref. (in)	F (Threads) (in)	G Ref. (in)	H (in)	J (in)	Weight (lb)
12-IDL-SPRK	7720-1500	8mm Pitch Poly Chain GT2	8MX-32S-12	12	32	3.145	1.25	0.50	0.85	1.56	3/4-16	0.94	2.75	-	1.0
21-IDL-SPRK	7720-1510		8MX-32S-21	21	32	3.145	1.25	0.50	1.24	1.56	3/4-16	0.56	2.75	-	1.1
36-IDL-SPRK	7720-1520		8MX-36S-36	36	36	3.546	1.91	0.75	1.86	1.63	3/4-16	-	-	-	2.0
62-IDL-SPRK	7720-1530		8MX-36S-62	62	36	3.546	1.91	0.75	2.91	1.69	3/4-16	0.69	3.13	-	2.1
20-IDL-SPRK	7720-1600		14mm Pitch Poly Chain GT2	14MX-30S-20	20	30	5.153	2.55	1.00	1.36	2.25	1-14	1.00	4.38	-
37-IDL-SPRK	7720-1610	14MX-30S-37		37	30	5.153	2.55	1.00	2.06	2.25	1-14	0.25	4.38	-	12.0
68-IDL-SPRK	7720-1620	14MX-34S-68		68	34	5.855	3.38	0.56	3.33	2.25	1-14	1.00	4.88	4.34	15.6
90-IDL-SPRK	7720-1640	14MX-34S-90		90	34	5.855	3.38	0.31	4.20	2.25	1-14	1.00	4.88	4.34	16.7
125-IDL-SPRK	7720-1630	14MX-35S-125		125	35	6.031	3.38	0.19	5.61	2.25	1-14	1.09	4.88	4.34	23.1

PowerGrip® GT® 2 Idler Dimensions

Part No.	Product No.	Use With	Size Designation	Belt Width (mm)	No. of Teeth	O.D. (in)	B Ref. (in)	C (in)	D (in)	E Ref. (in)	F (Threads) (in)	G Ref. (in)	H (in)	J (in)	Weight (lb)
20-SPK2-IDL	7720-1740	8mm Pitch PowerGrip GT2	32S-8MGT-20	20	32	3.154	1.25	0.50	1.24	1.56	3/4-16	0.56	2.75	-	1.1
30-SPK2-IDL	7720-1750		36S-8MGT-30	30	36	3.555	1.91	0.75	1.86	1.63	3/4-16	0.56	2.75	-	2.0
40-SPK2-IDL	7720-1850	14mm Pitch PowerGrip GT2	30S-14MGT-40	40	30	5.153	2.55	1.00	2.06	2.25	1-14	0.25	4.38	-	12.0
55-SPK2-IDL	7720-1860		34S-14MGT-55	55	34	5.855	3.38	0.56	3.33	2.25	1-14	1.00	4.38	4.34	15.6